

# **IP CAMERA**

## **( For Android phone )**

# **Instructions**

# Introduction

This product is made from high-performance chips to realize a media processor integrated with acquisition, compression and transmission on audio and video frequency. A standard Motion-JPEG/H.264 encoding algorithm ensures clearer and smoother video transmission effect. Users are allowed to perform centralized monitoring on clients and mobile phone clients via browsers, such as IE, thus conveniently realizing real-time monitoring and remote control on front cameras. This product has good reliability and compatibility as well as simple installation and easy operation, so users can connect the cameras to wideband networks within few minutes without any skills.

# Camera installation guide

Before setting, please make sure the camera is connected to the power and network cable,

 : Plug and play

## Mobile phone setting:

1. Downloading the Installation Application(**P2PCam3.9.apk**) in your smartphone, and

Enter into the installation interface, then click  :

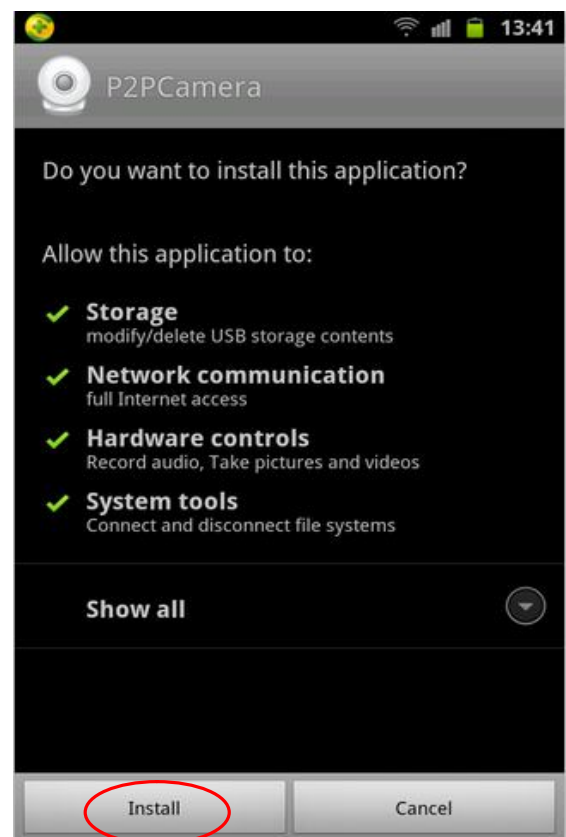

2. Waiting for Application installing, then Click

Open

:

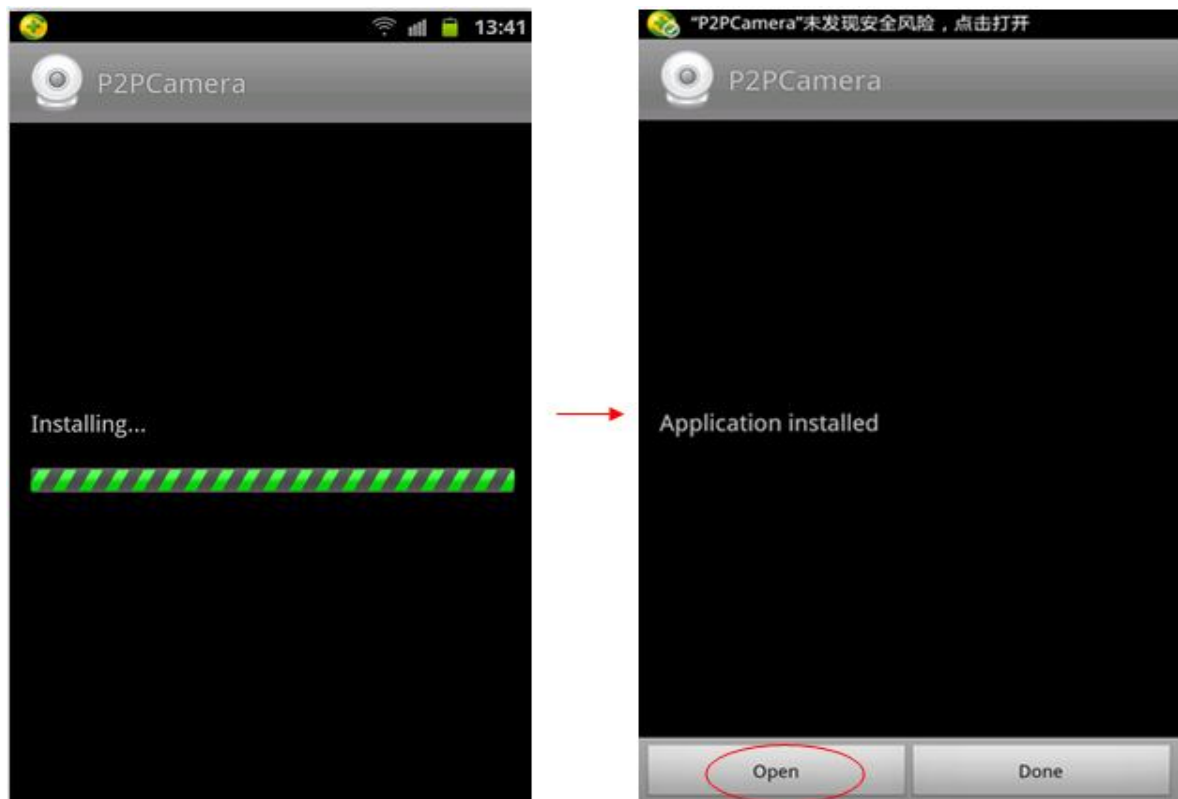

3. Please tap here to add new camera:

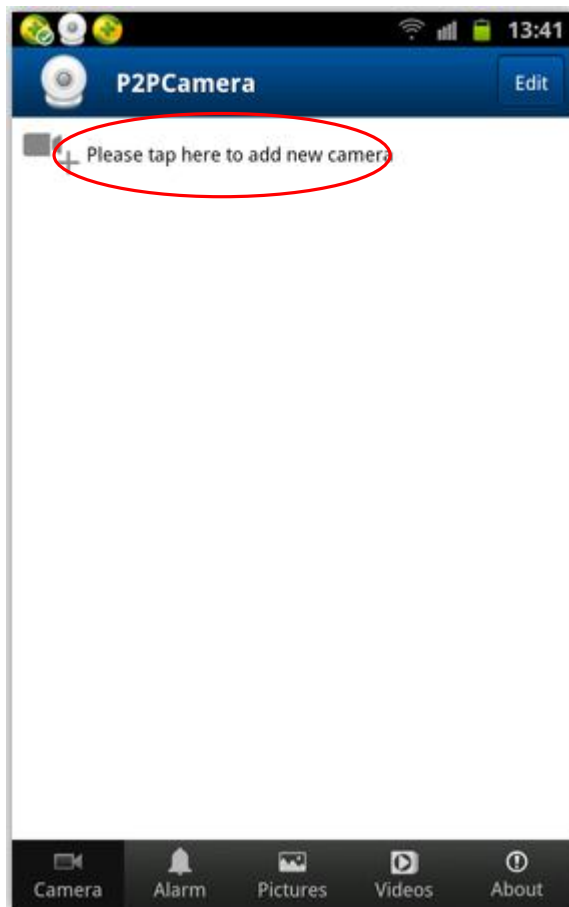

4. Please input the ID number (Note: ID number is showed on the label at the bottom of the camera), then click **done**:

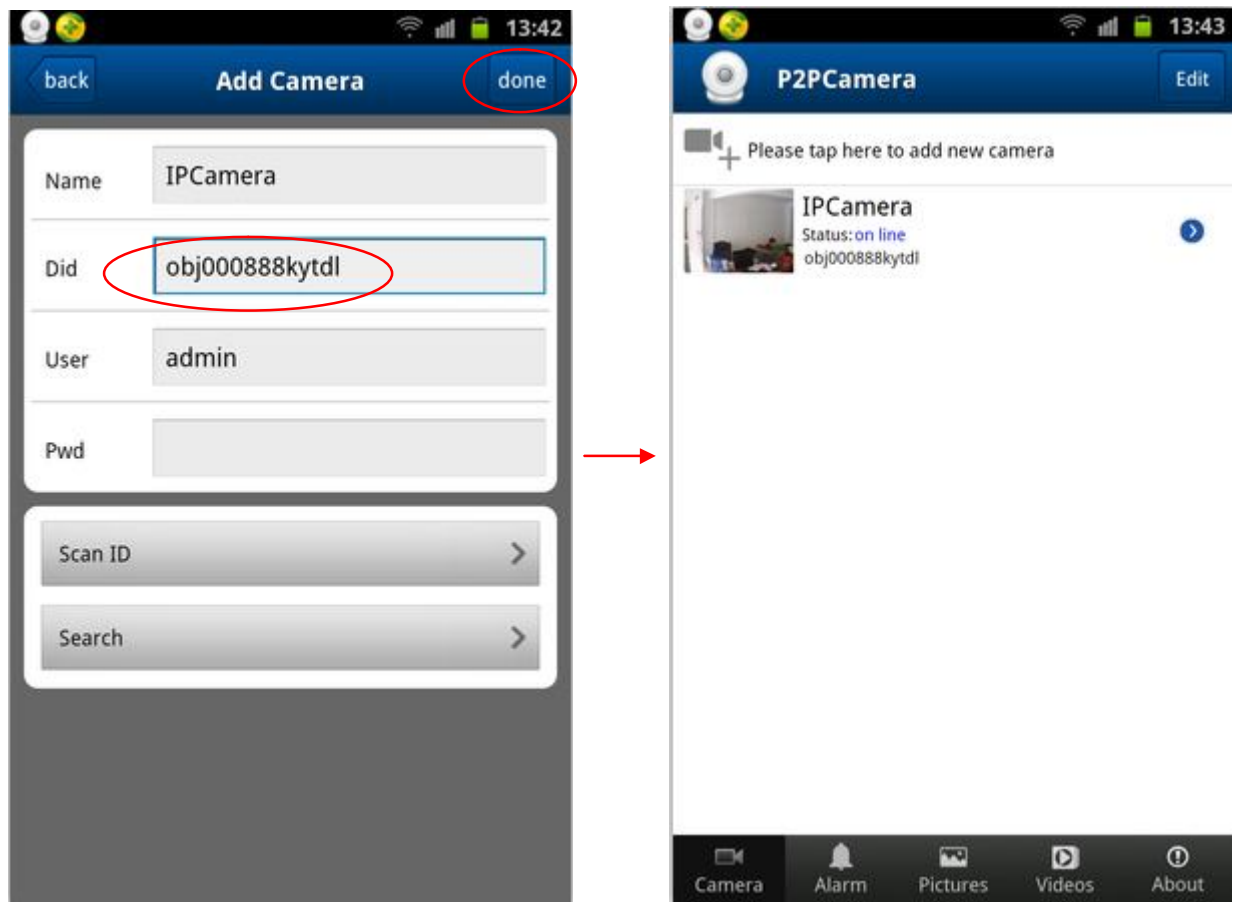

5. Now you enter into the monitoring interface:



6. Click the setting key of your mobile phone, Function keys will be showed on the screen:

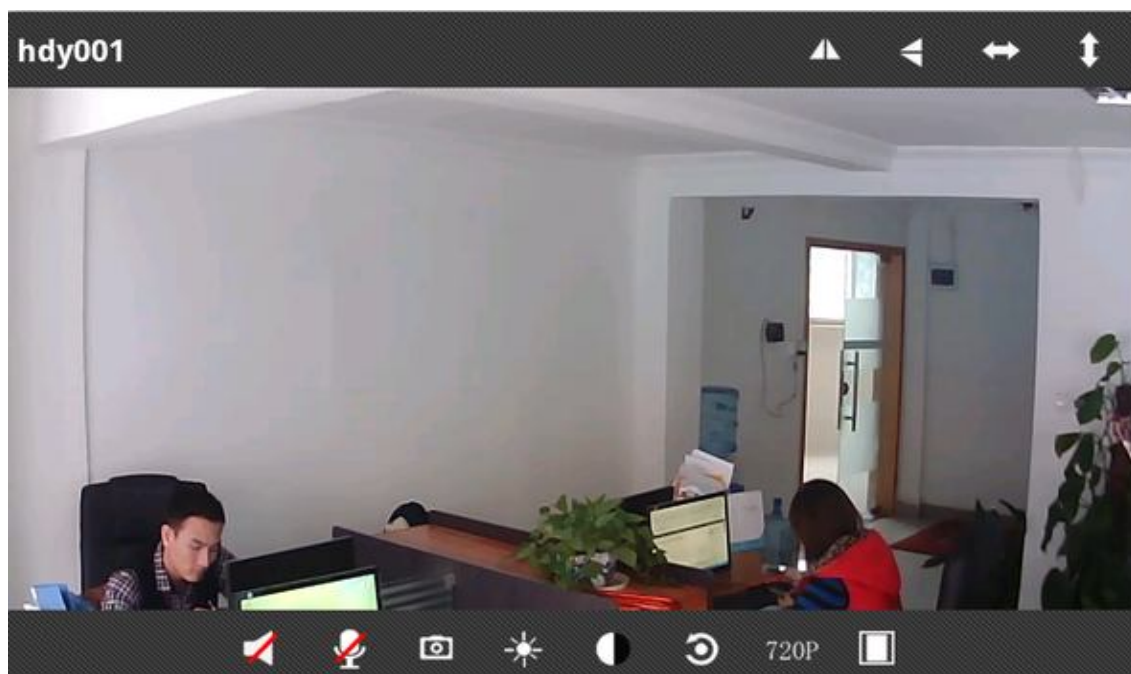

## 7. Function keys



Speaker



Microphone

(Two-way voice intercom when both are working)



Snapshot



Brightness



Contrast



Restore default values



Resolution



Screen size optional



## : Wireless and remote monitoring

1. Back to the previous step 4, and click  for WIFI setting:

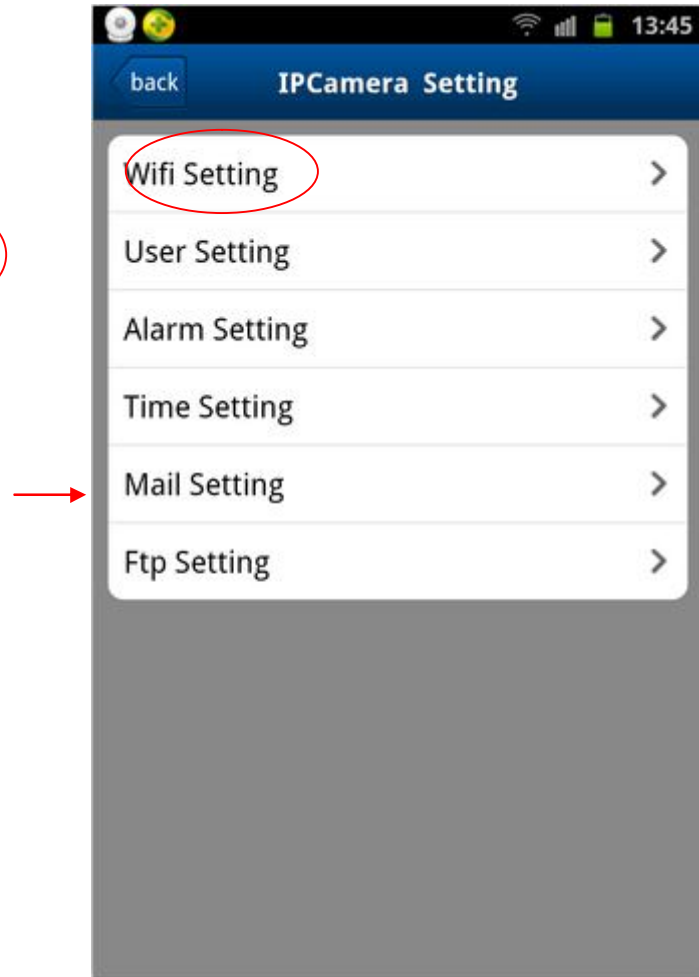
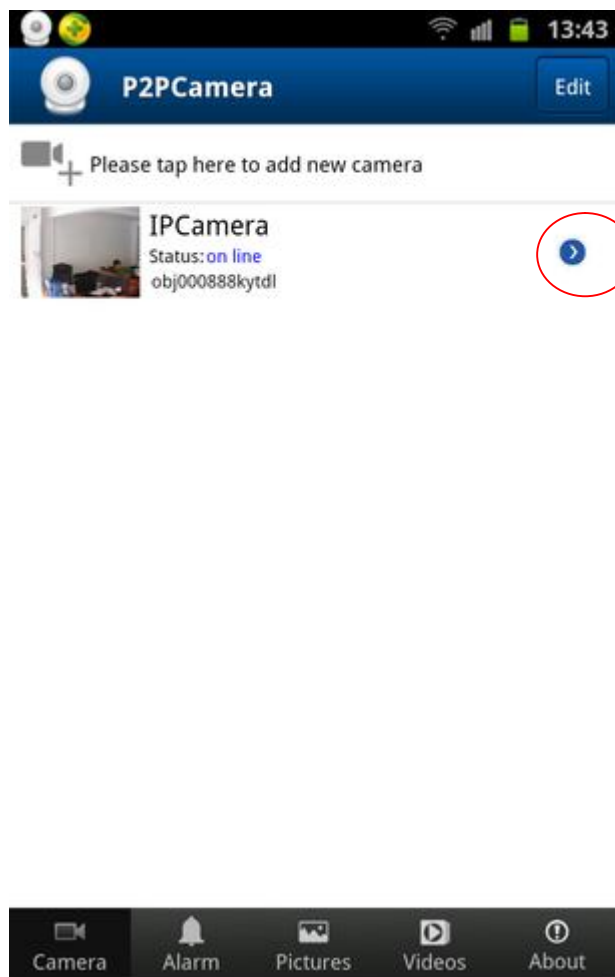

2. Click **Wifi Setting** to search your WIFI network, then enter into your WIFI password

and click **done**:

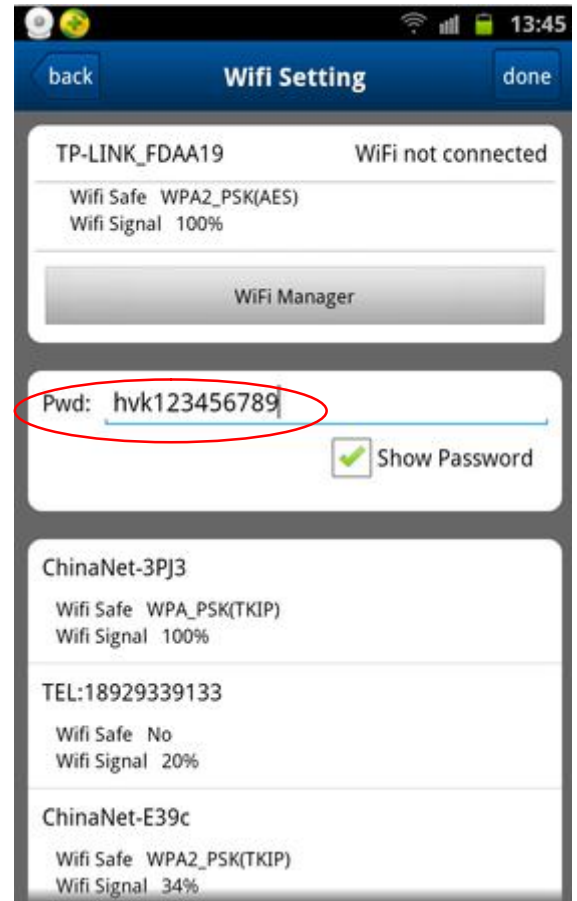
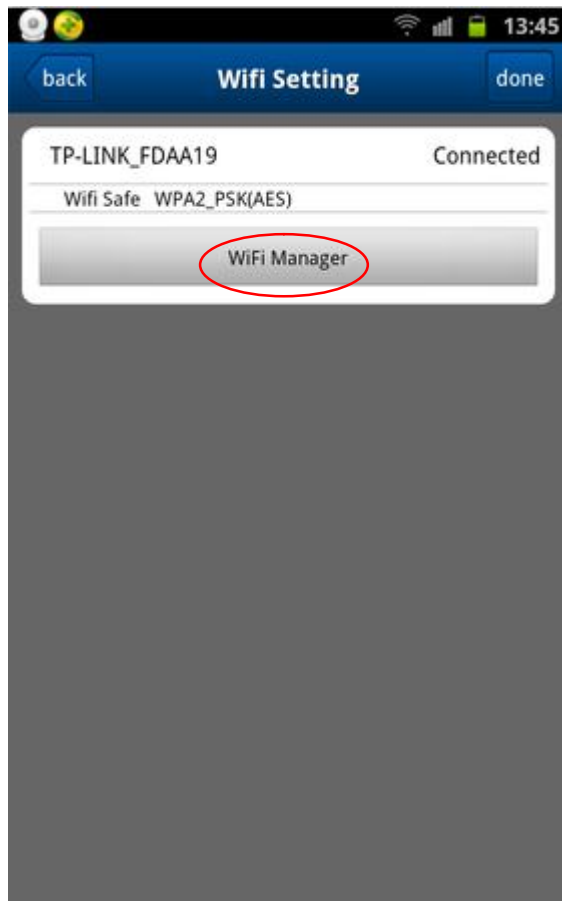

The camera connected your WIFI network successfully, now you can unplug the network cable for wireless and remote monitoring.

